

STEPPING ACTUATORS

PLG10-8000

FEATURES

- Small and big gear selectable
- Provided with connector terminals for easy connection
- RoHS compliant

APPLICATIONS

- Game machines
- Others



PART NUMBER DESIGNATION

PLG10 - 8000

Series name

Dash number

STANDARD SPECIFICATIONS

Item	PLG10-8000	Remarks
Excitation	2 phases bipolar	
Steps	20	2phases-EX.motor part
Maximum Pull-in pulse rate	700Hz Minimum	at DC5V
Maximum response frequency	1300Hz Minimum	at DC5V
Pull-in torque	10.78mN · m Minimum	at 240Hz, DC5V
Pull-out torque	16.18mN · m Minimum	at 240Hz, DC5V
Winding resistance	21.8Ω	
Insulation resistance	10MΩ Minimum	DC100V
Dielectric strenght	300Vrms	AC,sec
Operating temperature range	0 ~ 50 °C	
Net weight	16.5g	Reference value

Wiring diagram

04ZR-8M-P (Insulation-displacement connector) 、
 04ZR- 3 H-P (Insulation-displacement connectort)
 ZHR- 4 (Crimp connector)
 (Connector : SZH-002T-P 0.5)
 Male connector 06ZR-8M or ZHR-6 Made by J.S.T.
 Mfg. Co., Ltd
 Remarks : Either insulation-displacement connector
 or crimp connector will do

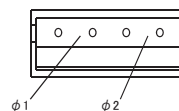
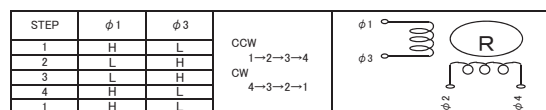

※ The characteristics are measured, using Copal's standard driving circuit.

Lot production is required. Please consult us for ordering.

PLG10-8000

STEPPING ACTUATORS

OUTLINE DIMENSIONS

Unless otherwise specified tolerance: ± 0.5 (Unit: mm)

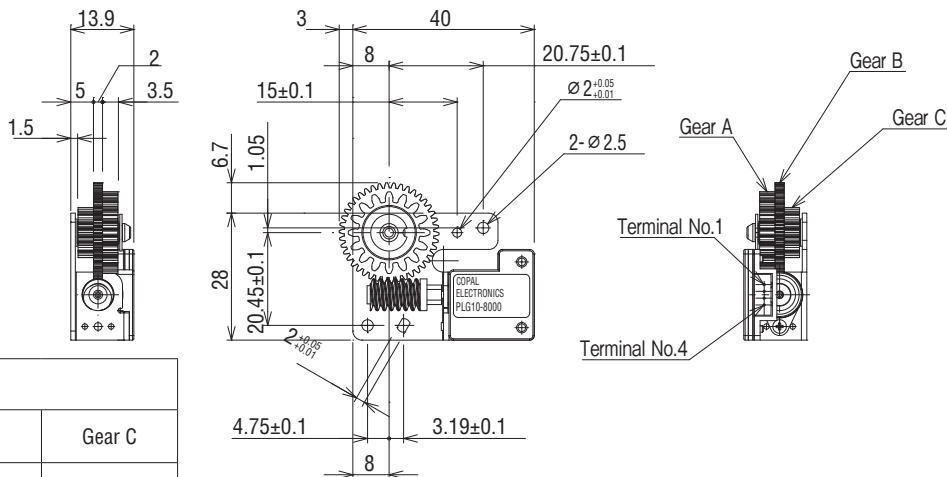

		Gear specification		
		Gear A	Gear B	Gear C
Tooth form		Involute	Involute	Involute
Module		1.0	0.5	1.0
Pressure angle		20°	20°	20°
Teeth number		16	42	8
Profile shift	X	0	0	+0.5
	Xm	0	0	+0.5

Pin layout	
1	$\phi 1$
2	$\phi 2$
3	$\phi 3$
4	$\phi 4$

PERFORMANCE CURVES

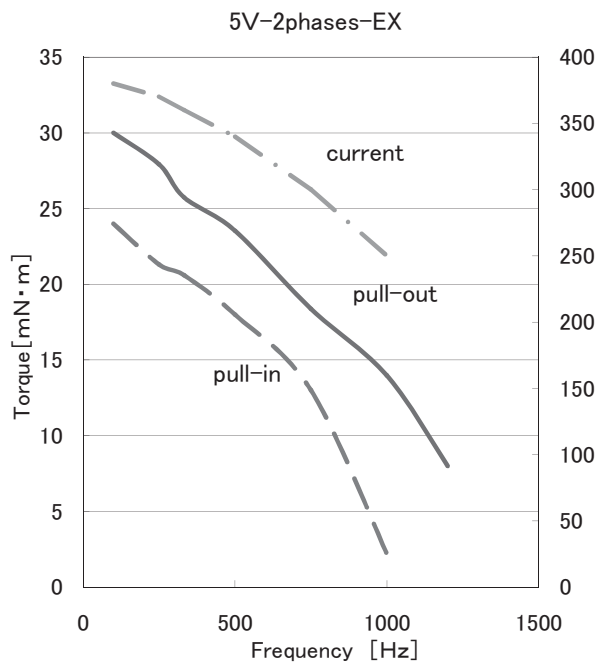

TEMPERATURE CHARACTERISTICS (REFERENCE)

